

# Cash Flow Fund 21

as of 9/13/07

<b>Date</b>	<b>Month's Activity</b>	<b>Cash Balance</b>	
07/01/07		56,033,495.56	
07/31/07	(4,334,272.92)	51,699,222.64	
08/30/07	(4,698,467.81)	47,000,754.83	
09/30/07	(6,500,000.00)	40,500,754.83	
10/26/07	(7,500,000.00)	33,000,754.83	Pay off Sun Trust Lease using \$1M of Measure E Money
11/30/07	(6,500,000.00)	26,500,754.83	
12/31/07	(6,500,000.00)	20,000,754.83	
01/31/08	(6,500,000.00)	13,500,754.83	
02/28/08	(6,500,000.00)	7,000,754.83	
03/31/08	(6,500,000.00)	500,754.83	sell bonds in March
	30,000,000.00	30,500,754.83	
04/30/08	(6,500,000.00)	24,000,754.83	
05/31/08	(6,500,000.00)	17,500,754.83	
06/30/08			
06/30/08			

Figures in italics are estimates

**Hemet Unified School District  
Measure T Bond Summary Report**

<b>School Site</b>	<b>Current Budget</b>	<b>Interest</b>	<b>Committed To Date</b>	<b>Balance</b>
Acacia	150,000.00		133,750.00	16,250.00
Bautista Creek	50,000.00		1,410.23	48,589.77
Cottonwood	2,500,000.00		2,467,862.07	32,137.93
Hamilton	500,000.00		356,395.33	143,604.67
Hemet El	200,000.00		101,960.00	98,040.00
Hemet High	3,500,000.00	32,898.00	3,532,533.81	364.19
Idyllwild	80,000.00	69,770.00	149,750.04	19.96
Little Lake	200,000.00		123,555.89	76,444.11
Ramona	500,000.00		444,732.59	55,267.41
Santa Fe	200,000.00		35,818.56	164,181.44
Valle Vista	20,000.00		6,740.45	13,259.55
West Valley High	600,000.00		560,945.45	39,054.55
Whittier	100,000.00		81,602.28	18,397.72
Winchester	400,000.00		113,148.87	286,851.13
Tahquitz High School	25,000,000.00		26,432,888.90	(1,432,888.90)
Rancho Viejo Middle	24,000,000.00		16,416,398.25	7,583,601.75
Page Ranch	1,000,000.00		789,773.26	210,226.74
Currie Ranch	1,000,000.00		848,087.95	151,912.05
Issuance Costs	750,450.00		338,205.05	412,244.95
Interest (to be disbursed)		912,054.00		912,054.00
<b>Total</b>	<b>\$ 60,750,450.00</b>	<b>\$ 1,014,722.00</b>	<b>\$ 52,935,558.98</b>	<b>\$ 8,829,613.02</b>

# Hemet Unified School District

## Expenditure Report

### Acacia Middle School

*Plumbing, electrical, mechanical systems and plant/classroom repairs, campus security, safety, technology and accessibility projects, facility equity augmentation and equipment.*

<b>Current Bond Budget</b>	\$	150,000.00
<b>Committed to Date</b>		<u>133,750.00</u>
<b>Balance</b>	\$	16,250.00

# Expenditure Report

Hemet Unified School District

ACACIA MEASURE T BOND

Project# Measure T Acacia

Vendor	Contract Description	PO#/ Contract	Contract Amount	Payments to Date	Balance
<b>Fund (70) Measure T Bond</b>					
douglas e barnhart	Construction Management	C12131	\$133,750.00	\$0.00	\$133,750.00
<b>Totals for Fund (70) Measure T Bond - 1 detail record</b>			<b>\$133,750.00</b>	<b>\$0.00</b>	<b>\$133,750.00</b>

**Hemet Unified School District**  
**Expenditure Report**  
**Bautista Creek**

*Campus security, safety, technology and accessibility projects,  
facility equity augmentation and equipment, replace portable classrooms*

<b>Current Bond Budget</b>	\$ 50,000.00
<b>Committed to Date</b>	<u>1,410.23</u>
<b>Balance</b>	\$ 48,589.77

# Expenditure Report

Hemet Unified School District

BAUTISTA CREEK MEASURE T BOND

Project# Measure T Bautista

Vendor	Contract Description	PO#/ Contract	Contract Amount	Payments to Date	Balance
<b>Fund (70) Measure T Bond</b>					
Tri Best Visual Display Prod	White Boards	P59949	\$1,410.23	\$1,410.23	\$0.00
<b>Totals for Fund (70) Measure T Bond - 1 detail record</b>			<b>\$1,410.23</b>	<b>\$1,410.23</b>	<b>\$0.00</b>

5

**Hemet Unified School District**  
**Expenditure Report**  
**Cottonwood**

*Water well and fire protection, water conservation,  
Plumbing, electrical, mechanical systems and plant/classroom repairs, campus security, safety,  
technology and accessibility projects, facility equity augmentation and equipment.*

<b>Current Bond Budget *</b>	\$ 2,500,000.00
<b>Committed to Date</b>	<u>2,467,862.07</u>
<b>Balance</b>	\$ 32,137.93

\* Additional \$500,000 to be allocated from 07/08 bond sale



# Expenditure Report

Hemet Unified School District

COTTONWOOD MEASURE T BOND

Project# Measure T Cottonwood

Vendor	Contract Description	PO#/ Contract	Contract Amount	Payments to Date	Balance
<b>Fund (70) Measure T Bond</b>					
All American Inspection	In Plant Inspection	P59132	\$650.00	\$650.00	\$0.00
Barnhart Labor Compliance	Labor Compliance Services	C1220062	\$19,545.00	\$0.00	\$19,545.00
Caldwell Land Surveys	Topographic Survey for Well	P58766	\$2,100.00	\$2,100.00	\$0.00
Caldwell Land Surveys	Survey	P6000028	\$10,100.00	\$6,060.00	\$4,040.00
Creative Contractors	Remove & Reinstall Swing	P59612	\$2,800.00	\$2,800.00	\$0.00
Creative Contractors	Relocate Climber	P6001181	\$2,400.00	\$0.00	\$2,400.00
douglas e barnhart	Construction Management	C12121	\$175,000.00	\$113,803.00	\$61,197.00
douglas e barnhart Trust Acct	Trust Account	C12155	\$1,806,277.00	\$521,876.70	\$1,284,400.30
Geovision	Geophysical Survey	P58833	\$3,700.00	\$3,700.00	\$0.00
Hadley Tow	Move 5 Containers	P6000629	\$975.00	\$975.00	\$0.00
Inland Foundation Eng Inc	Percolation Investigation	P59889	\$10,350.00	\$10,350.00	\$0.00
Inland Foundation Eng Inc	Construction Testing	P6000132	\$20,312.00	\$8,673.50	\$11,638.50
Inland Foundation Eng Inc	Trench Inspection	P6001183	\$4,900.00	\$0.00	\$4,900.00
Kevin Waite	Inspection	C12124	\$10,000.00	\$8,260.00	\$1,740.00
Modular Structures	1 relocatable classroom and 1 restroom	P59137	\$160,583.00	\$136,424.70	\$24,158.30
PJHM	Architect Fees	C11734	\$125,625.00	\$25,125.00	\$100,500.00
PJHM	Architect Fees Well and Tank System	C11946	\$103,893.13	\$86,110.82	\$17,782.31
Riverside County Clerk	Filing Fee for CEQA	CL120961	\$64.00	\$64.00	\$0.00
Safety Screens	Safety Screens	P59870	\$1,055.10	\$1,055.10	\$0.00
San Jacinto Electric	Electrical Work	P59654	\$3,037.50	\$3,037.50	\$0.00
Sladden Engineering	Soil Engineering & Sewage Disposal Feasibility	P59127	\$3,500.00	\$3,500.00	\$0.00
Thompson Engineering	Connect New Portables to Communication System	P6000027	\$995.34	\$0.00	\$995.34
<b>Totals for Fund (70) Measure T Bond - 22 detail records</b>			<b>\$2,467,862.07</b>	<b>\$934,565.32</b>	<b>\$1,533,296.75</b>

District: Hemet Unified School District

Printed on: 09/13/2007 at 09:34 AM

Page 1 of 2

© Copyright 2000, Vavrinek, Trine, Day & Company, LLP. All Rights Reserved.



# Hemet Unified School District

## Expenditure Report

### Hamilton

*Permanent classroom additions, replacement of portable classrooms.*

*Plumbing, electrical, mechanical systems and plant/classroom repairs, campus security, safety, technology and accessibility projects, water conservation, facility equity augmentation and equipment.*

<b>Current Bond Budget</b>	\$ 500,000.00
<b>Committed to Date</b>	<u>356,395.33</u>
<b>Balance</b>	\$ 143,604.67

# Expenditure Report

Hemet Unified School District

HAMILTON MEASURE T BOND

Project# Measure T Hamilton

Vendor	Contract Description	PO#/Contract	Contract Amount	Payments to Date	Balance
<b>Fund (70) Measure T Bond</b>					
All American Inspection	In Plant Inspection	P59131	\$300.00	\$300.00	\$0.00
douglas e barnhart	Construction Management	C12132	\$43,750.00	\$6,202.00	\$37,548.00
douglas e barnhart	Construction Management	C12133	\$13,750.00	\$5,000.00	\$8,750.00
Inland Foundation Eng Inc	Construction Testing	P6000133	\$8,112.00	\$4,355.40	\$3,756.60
J Glenna Construction	Site Prep & Relo Installation	P6000130	\$169,999.00	\$161,678.30	\$8,320.70
Kevin Waite	Inspection	C12126	\$5,000.00	\$2,660.00	\$2,340.00
Modular Structures	24 X 60 Modular Office Classroom	P59139	\$70,950.00	\$62,299.80	\$8,650.20
North American Fence & Supply	Fencing	P6000158	\$19,370.00	\$0.00	\$19,370.00
PJHM	Architect Fees	C1220007	\$20,000.00	\$17,847.32	\$2,152.68
Safety Screens	Safety Screens	P59871	\$3,237.04	\$3,237.04	\$0.00
Thompson Engineering	Speaker Installation	P59874	\$1,927.29	\$0.00	\$1,927.29
<b>Totals for Fund (70) Measure T Bond - 11 detail records</b>			<b>\$356,395.33</b>	<b>\$263,579.86</b>	<b>\$92,815.47</b>

# Hemet Unified School District

## Expenditure Report

### Hemet Elementary

*Plumbing, electrical, mechanical systems and plant/classroom repairs, campus security, safety, technology and accessibility projects, facility equity augmentation and equipment.*

<b>Current Bond Budget</b>	\$	200,000.00
<b>Committed to Date</b>		101,960.00
<b>Balance</b>	\$	98,040.00

# Expenditure Report

Hemet Unified School District

HEMET EL MEASURE T BOND

Project# Measure T Hemet EI

Vendor	Contract Description	PO#/ Contract	Contract Amount	Payments to Date	Balance
<b>Fund (70) Measure T Bond</b>					
douglas e barnhart	Construction Management	C12134	\$96,250.00	\$497.00	\$95,753.00
Inland Foundation Eng Inc	Construction Testing	P6000030	\$710.00	\$0.00	\$710.00
Kevin Waite	Inspection	C12123	\$5,000.00	\$0.00	\$5,000.00
<b>Totals for Fund (70) Measure T Bond - 3 detail records</b>			<b>\$101,960.00</b>	<b>\$497.00</b>	<b>\$101,463.00</b>

**Hemet Unified School District  
Expenditure Report  
Hemet High**

*Plumbing, electrical, mechanical systems and plant/classroom repairs, campus security, safety, technology and accessibility projects, facility equity augmentation and equipment.*

<b>Current Bond Budget *</b>	\$ 3,500,000.00
<b>Interest</b>	32,898.00
<b>Committed to Date</b>	<u>3,532,533.81</u>
<b>Balance</b>	\$ 364.19

\* Additional \$22,500,000 to be allocated from 07/08 bond sale  
Additional \$5,000,000 to be allocated from 08/09 bond sale



# Expenditure Report

Hemet Unified School District

HEMET HIGH MEASURE T BOND

Project# Measure T Hemet High

Vendor	Contract Description	PO#/Contract	Contract Amount	Payments to Date	Balance
<b>Fund (70) Measure T Bond</b>					
Aardvark Clay & Supplies	Clay Pugmill Mixer	P58846	\$3,259.44	\$3,259.44	\$0.00
Barnhart Labor Compliance Services	Labor Compliance Services	C12101	\$65,720.00	\$11,709.00	\$54,011.00
Bills Fence	Fencing	P6001227	\$2,665.00	\$0.00	\$2,665.00
Creative Contractors	Remove Existing Foul Poles & Install New	P6000052	\$7,800.00	\$0.00	\$7,800.00
Dave Bang Assoc	Foul Poles	P6000036	\$9,096.26	\$9,096.26	\$0.00
Department of General Services	CMAS Fees for Spectrum	CL124095	\$304.15	\$304.15	\$0.00
Division of State Architect	DSA Plan Check Fee	CL123352	\$4,814.20	\$4,814.20	\$0.00
douglas e barnhart	Construction Management	C12119	\$100,000.00	\$16,639.00	\$83,361.00
douglas e barnhart	Construction Management	C12140	\$423,392.00	\$132,746.00	\$290,646.00
douglas e barnhart	Trust Acct Phase 3	C12149	\$1,148,000.00	\$1,030,162.50	\$117,837.50
First American Title	Title Search	CL123120	\$750.00	\$750.00	\$0.00
Flores Lund Consultants	Survey Mapping	P59825	\$18,212.00	\$8,694.00	\$9,518.00
Flores Lund Consultants	Civil Engineering & Traffic Engineering	P6000684	\$24,694.00	\$9,255.72	\$15,438.28
Inland Foundation Eng Inc	Compaction Testing	P58945	\$16,190.00	\$15,647.87	\$542.13
Laguna Clay Co	Gas Kiln	P59641	\$11,933.84	\$11,933.84	\$0.00
Martin Container	Rent Storage Container for Temporary Storage	P59141	\$770.41	\$770.41	\$0.00
Pacific Alarm	Alarm System Installation	P58414	\$2,375.00	\$2,375.00	\$0.00
PJHM	Architect Fees	C11652	\$28,164.04	\$23,963.50	\$4,200.54
San Jacinto Electric	Electrical Work	P59655	\$1,183.83	\$1,183.83	\$0.00
Spectrum Communications	Cabling	P58567	\$14,060.78	\$12,633.77	\$1,427.01
Spectrum Communications	Remove Fiber from Team Room	P59610	\$1,500.00	\$1,500.00	\$0.00
Thompson Engineering	Install Communication Equipment	P58415	\$4,148.86	\$0.00	\$4,148.86
Trittipo Architecture & Planning	Architect Fees for Remodel	C12161	\$1,643,500.00	\$115,950.00	\$1,527,550.00
<b>Totals for Fund (70) Measure T Bond - 23 detail records</b>			<b>\$3,532,533.81</b>	<b>\$1,413,388.49</b>	<b>\$2,119,145.32</b>

District: Hemet Unified School District

Printed on: 09/13/2007 at 09:35 AM

Page 1 of 2

© Copyright 2000, Vavrinek, Trine, Day & Company, LLP. All Rights Reserved.

13

**Hemet Unified School District**  
**Expenditure Report**  
**Idyllwild**

*Plumbing, electrical, mechanical systems and plant/classroom repairs, campus security, safety, technology and accessibility projects, facility equity augmentation and equipment.*

<b>Current Bond Budget</b>	\$	80,000.00
<b>Interest</b>		69,770.00
<b>Committed to Date</b>		<u>149,750.04</u>
<b>Balance</b>	\$	19.96

# Expenditure Report

Hemet Unified School District

IDYLLWILD MEASURE T BOND

Project# Measure T Idyllwild

Vendor	Contract Description	PO#/ Contract	Contract Amount	Payments to Date	Balance
<b>Fund (70) Measure T Bond</b>					
douglas e barnhart	Construction Management	C12135	\$63,125.00	\$534.00	\$62,591.00
North American Fence & Supply	Fencing	P6000158	\$51,328.00	\$0.00	\$51,328.00
Peter Gulassa	Retaining Wall	P58896	\$3,700.00	\$3,700.00	\$0.00
PJHM	Architect Fees	C1220055	\$25,000.00	\$0.00	\$25,000.00
Tri Best Visual Display Prod	Whiteboards	P59949	\$6,597.04	\$6,597.04	\$0.00
<b>Totals for Fund (70) Measure T Bond - 5 detail records</b>			<b>\$149,750.04</b>	<b>\$10,831.04</b>	<b>\$138,919.00</b>

**Hemet Unified School District**  
**Expenditure Report**  
**Little Lake**

*Plumbing, electrical, mechanical systems and plant/classroom repairs, campus security, safety, technology and accessibility projects, classroom replacements and building additions, facility equity augmentation and equipment.*

<b>Current Bond Budget</b>	\$	200,000.00
<b>Committed to Date</b>		<u>123,555.89</u>
<b>Balance</b>	\$	76,444.11



# Expenditure Report

Hemet Unified School District

LITTLE LAKE MEASURE T BOND

Project# Measure T Little Lake

Vendor	Contract Description	PO#/ Contract	Contract Amount	Payments to Date	Balance
<b>Fund (70) Measure T Bond</b>					
Bills Fence	Fencing	P6000092	\$9,925.00	\$9,925.00	\$0.00
Creative Contractors	Install Shade Shelter	P6000050	\$9,900.00	\$0.00	\$9,900.00
Dave Bang Assoc	Shade Shelter	P6000038	\$14,754.77	\$0.00	\$14,754.77
douglas e barnhart	Construction Management	C12136	\$40,000.00	\$3,102.00	\$36,898.00
PCH Architects	Architect Fees Shade Shelter	P6000682	\$9,000.00	\$0.00	\$9,000.00
Peter Gulassa	Concrete Work	P6000070	\$2,875.00	\$2,875.00	\$0.00
Thompson Engineering	Communication System	P59657	\$35,102.00	\$28,432.62	\$6,669.38
Tot Turf by Robertson Industries	Repair Post Holes	P6000054	\$1,999.12	\$0.00	\$1,999.12
<b>Totals for Fund (70) Measure T Bond - 8 detail records</b>			<b>\$123,555.89</b>	<b>\$44,334.62</b>	<b>\$79,221.27</b>

17



**Hemet Unified School District  
Expenditure Report  
Ramona**

*Plumbing, electrical, mechanical systems and plant/classroom repairs, campus security, safety, technology and accessibility projects, classroom replacements and building additions, facility equity augmentation and equipment.*

<b>Current Bond Budget</b>	\$	500,000.00
<b>Committed to Date</b>		<u>444,732.59</u>
<b>Balance</b>	\$	55,267.41

# Expenditure Report

Hemet Unified School District

RAMONA MEASURE T BOND

Project# Measure T Ramona

Vendor	Contract Description	PO#/ Contract	Contract Amount	Payments to Date	Balance
<b>Fund (70) Measure T Bond</b>					
All American Inspection	In Plant Inspection	P59134	\$600.00	\$600.00	\$0.00
Division of State Architect	DSA Plan Check Fees	CL119875	\$900.00	\$900.00	\$0.00
douglas e barnhart	Construction Management	C12137	\$210,000.00	\$0.00	\$210,000.00
Inland Foundation Eng Inc	Construction Testing	P6000031	\$1,612.00	\$0.00	\$1,612.00
J Glenna Construction	Sidewalk	P6000034	\$6,600.00	\$6,600.00	\$0.00
Kevin Waite	Inspection	C12125	\$5,000.00	\$560.00	\$4,440.00
Modular Structures	24 x 40 Standard Modular Classroom	P59140	\$124,268.00	\$95,641.20	\$28,626.80
PCH Architects	Architect Fees	C12105	\$20,000.00	\$0.00	\$20,000.00
PCH Architects	Architect Fees - 2 Relos	C12147	\$9,700.00	\$7,760.00	\$1,940.00
R Jensen Co	Site work & Install 2 Relocatable Classrooms	P6000039	\$53,000.00	\$47,700.00	\$5,300.00
Safety Screens	Safety Screens	P59877	\$1,960.20	\$1,960.20	\$0.00
San Jacinto Electric	Electrical Work	P6001182	\$1,200.00	\$0.00	\$1,200.00
Spectrum Communications	Install Cabling to Connect new Relos	P6000042	\$8,050.38	\$0.00	\$8,050.38
Thompson Engineering	Connect Communication Systems to new Relos	P59875	\$1,842.01	\$0.00	\$1,842.01
<b>Totals for Fund (70) Measure T Bond - 14 detail records</b>			<b>\$444,732.59</b>	<b>\$161,721.40</b>	<b>\$283,011.19</b>

**Hemet Unified School District**  
**Expenditure Report**  
**Santa Fe Middle School**

*Plumbing, electrical, mechanical systems and plant/classroom repairs, campus security, safety, technology and accessibility projects, facility equity augmentation and equipment.*

<b>Current Bond Budget</b>	\$	200,000.00
<b>Committed to Date</b>		<u>35,818.56</u>
<b>Balance</b>	\$	164,181.44

# Expenditure Report

Hemet Unified School District

SANTA FE MEASURE T BOND

Project# Measure T Santa Fe

Vendor	Contract Description	PO#/ Contract	Contract Amount	Payments to Date	Balance
<b>Fund (70) Measure T Bond</b>					
Fence Builders	Fencing	P58909	\$11,300.50	\$11,300.50	\$0.00
Gopher Sports	Floor Mats	P6000163	\$2,815.48	\$2,815.48	\$0.00
Peter Gulassa	Remodel Fitness Room	P6000620	\$13,150.00	\$13,150.00	\$0.00
San Jacinto Electric	Electrial Work Wood Shop	P6000628	\$3,300.00	\$0.00	\$3,300.00
Tri Best Visual Display Prod	White Boards	P59949	\$5,252.58	\$5,252.58	\$0.00
<b>Totals for Fund (70) Measure T Bond - 5 detail records</b>			<b>\$35,818.56</b>	<b>\$32,518.56</b>	<b>\$3,300.00</b>

21

**Hemet Unified School District  
Expenditure Report  
Valle Vista**

*Campus security, safety, technology and accessibility projects,  
facility equity augmentation and equipment.*

<b>Current Bond Budget</b>	\$	20,000.00
<b>Committed to Date</b>		<u>6,740.45</u>
<b>Balance</b>	\$	13,259.55



# Expenditure Report

Hemet Unified School District

VALLE VISTA MEASURE T BOND

Project# Measure T Valle Vista

Vendor	Contract Description	PO#/ Contract	Contract Amount	Payments to Date	Balance
<b>Fund (70) Measure T Bond</b>					
Tri Best Visual Display Prod	Whiteboards	P59949	\$6,740.45	\$6,740.45	\$0.00
<i>Totals for Fund (70) Measure T Bond - 1 detail record</i>			<b>\$6,740.45</b>	<b>\$6,740.45</b>	<b>\$0.00</b>

**Hemet Unified School District**  
**Expenditure Report**  
**West Valley**

*Campus security, safety, technology and accessibility projects and site improvements,  
facility equity augmentation and equipment.*

<b>Current Bond Budget</b>	\$ 600,000.00
<b>Committed to Date</b>	<u>560,945.45</u>
<b>Balance</b>	\$ 39,054.55

# Expenditure Report

Hemet Unified School District

WEST VALLEY MEASURE T BOND

Project# Measure T West Valley

Vendor	Contract Description	PO#/Contract	Contract Amount	Payments to Date	Balance
<b>Fund (70) Measure T Bond</b>					
Bills Fence	Fencing	P6000621	\$12,250.00	\$12,250.00	\$0.00
Creative Contractors	Remove existing and install new foul poles	P6000053	\$7,800.00	\$7,800.00	\$0.00
Dave Bang Assoc	Foul Poles, Benches, Bleachers	P6000035	\$16,220.95	\$16,220.95	\$0.00
douglas e barnhart	Construction Management	C12130	\$74,687.00	\$7,509.00	\$67,178.00
Flores Lund Consultants	Survey Mapping Services	C1220100	\$15,550.00	\$0.00	\$15,550.00
Louies Nursery	Groundcover	P58938	\$6,885.23	\$6,885.23	\$0.00
Peter Gulassa	Move & Reinstall Bleachers JV Field	P6000047	\$1,275.00	\$1,275.00	\$0.00
Peter Gulassa	Install bleachers in Softball field	P6000048	\$4,850.00	\$4,850.00	\$0.00
PJHM	Architect Fees Gym Floor	C1220005	\$35,000.00	\$33,250.00	\$1,750.00
PJHM	Architect Fee Improvements	C1220054	\$141,000.00	\$14,100.00	\$126,900.00
San Jacinto Electric	Electrical Work	P6000627	\$4,800.00	\$0.00	\$4,800.00
Temecula Valley Pipe & Supply	Jute for Groundcover project	P58897	\$1,777.27	\$1,777.27	\$0.00
Western Flooring Inc	Replace Gym Floor	P6000157	\$238,850.00	\$174,285.00	\$64,565.00
<b>Totals for Fund (70) Measure T Bond - 13 detail records</b>			<b>\$560,945.45</b>	<b>\$280,202.45</b>	<b>\$280,743.00</b>

**Hemet Unified School District**  
**Expenditure Report**  
**Whittier**

*Plumbing, electrical, mechanical systems and plant/classroom repairs, campus security, safety, technology and accessibility projects, classroom replacements and building additions, facility equity augmentation and equipment.*

<b>Current Bond Budget</b>	\$	100,000.00
<b>Committed to Date</b>		<u>81,602.28</u>
<b>Balance</b>	\$	18,397.72

# Expenditure Report

Hemet Unified School District

WHITTIER MEASURE T BOND

Project# Measure T Whittier

Vendor	Contract Description	PO#/ Contract	Contract Amount	Payments to Date	Balance
<b>Fund (70) Measure T Bond</b>					
douglas e barnhart	Construction Management	C12138	\$48,750.00	\$0.00	\$48,750.00
Tri Best Visual Display Prod	White Boards	P59949	\$32,852.28	\$32,852.28	\$0.00
<b>Totals for Fund (70) Measure T Bond - 2 detail records</b>			<b>\$81,602.28</b>	<b>\$32,852.28</b>	<b>\$48,750.00</b>



**Hemet Unified School District**  
**Expenditure Report**  
**Winchester**

*Plumbing, electrical, mechanical systems and plant/classroom repairs, campus security, safety, technology and accessibility projects, classroom replacements and building additions, facility equity augmentation and equipment.*

<b>Current Bond Budget</b>	\$	400,000.00
<b>Committed to Date</b>		<u>113,148.87</u>
<b>Balance</b>	\$	286,851.13

# Expenditure Report

Hemet Unified School District

WINCHESTER MEASURE T BOND

Project# Measure T Winchester

Vendor	Contract Description	PO#/ Contract	Contract Amount	Payments to Date	Balance
<b>Fund (70) Measure T Bond</b>					
Creative Contractors	Remove old & Install new Shade Structure	P6000051	\$16,400.00	\$0.00	\$16,400.00
Dave Bang Assoc	Shade Structure	P6000037	\$19,541.61	\$0.00	\$19,541.61
douglas e barnhart	Construction Management	C12118	\$50,000.00	\$0.00	\$50,000.00
PCH Architects	Achitect Fees for Shade Shelter	P6000683	\$9,000.00	\$0.00	\$9,000.00
Peter Gulassa	Install Whiteboards	P6000988	\$3,200.00	\$3,200.00	\$0.00
Shiffler Equipment Sales Inc	Whiteboards	P6000131	\$15,007.26	\$0.00	\$15,007.26
<b>Totals for Fund (70) Measure T Bond - 6 detail records</b>			<b>\$113,148.87</b>	<b>\$3,200.00</b>	<b>\$109,948.87</b>

**Hemet Unified School District  
Expenditure Report  
Tahquitz High School**

Measure E Bond Allocation	\$ 15,618,397.00
Measure T Bond Allocation	30,000,000.00
CFD's	9,038,141.00
Savings from Harmony,McSweeny,Diamond Valley	2,214,288.00
Developer Fees	4,231,512.00
State Grant Budget	30,369,098.00
Design Money released from State	7,496,640.00
Energy Funding - OPSC	1,184,459.00
Interest	<u>228,536.27</u>
<b>Total Budget</b>	<b>100,381,071.27</b>
<b>Current Measure T Budget *</b>	\$ 25,000,000.00
<b>Committed to Date</b>	<u>26,432,888.90</u>
<b>Measure T Balance</b>	<b>\$ (1,432,888.90)</b>

\* Additional \$5,000,000 to be allocated from 07/08 bond sale.

# Expenditure Report

Hemet Unified School District

TAHQUITZ HIGH SCHOOL

Project# 50/67082-00-08

Vendor	Contract Description	PO#/ Contract	Contract Amount	Payments to Date	Balance
<b>Fund (70) Measure T Bond</b>					
Ballard Gas Service	Propane System	P6000691	\$533.67	\$533.67	\$0.00
Barnhart Labor Compliance Services	Labor Compliance Services	C11769(70)	\$219,106.00	\$33,511.00	\$185,595.00
Bogle Inspection Services	Inspection	C11814(70)	\$54,000.00	\$40,800.00	\$13,200.00
Caldwell Land Surveys	Survey Phase 2	P6000000	\$19,000.00	\$15,200.00	\$3,800.00
Caldwell Land Surveys	Survey for Phase III	P6001266	\$33,500.00	\$0.00	\$33,500.00
City of Hemet	Waste Removal	P53930(70)	\$28,335.97	\$7,680.94	\$20,655.03
Dave Bang Assoc	Steel Bleachers	P58950	\$9,552.41	\$0.00	\$9,552.41
Division of State Architect	DSA Plan Check Fees	CL118575	\$25,050.00	\$25,050.00	\$0.00
douglas e barnhart	Construction Management Phase 2	C12120	\$1,000,000.00	\$511,627.00	\$488,373.00
douglas e barnhart	Construction Management Phase 3 (Stadium)	C1220008	\$962,471.00	\$24,696.00	\$937,775.00
douglas e barnhart Trust Acct	Trust Acct for Phase 2	C12154	\$16,692,562.00	\$5,451,956.10	\$11,240,605.90
douglas e barnhart Trust Acct	Trust Acct Phase 3 (Stadium)	C1220112	\$9,038,698.00	\$0.00	\$9,038,698.00
Eastern Municipal Water District	Plan Check Deposit	CL124366	\$4,000.00	\$4,000.00	\$0.00
Eastern Municipal Water District	Water Usage & Backflow Tests	CL124611	\$322.00	\$322.00	\$0.00
Eastern Municipal Water District	Water Usage	P6001179	\$20,000.00	\$0.00	\$20,000.00
Empire & Associates	Vault & Catch Basin Covers	P59879	\$875.00	\$0.00	\$875.00
Flores Lund Consultants	Civil Engineering	C1220004	\$5,000.00	\$2,443.78	\$2,556.22
Inland Foundation Eng Inc	Construction Testing Phase II	C12127	\$221,307.00	\$54,738.72	\$166,568.28
Inland Foundation Eng Inc	Construction Testing Phase III	C12128	\$88,050.00	\$14,616.25	\$73,433.75
Mark-Costello Co	Trash Compactors	P6000073	\$21,857.00	\$21,857.00	\$0.00
Mobile Storage Group	Relocate storage unit	P6000744	\$363.66	\$0.00	\$363.66
Salsbury Industries	Courier Box	P59872	\$628.36	\$0.00	\$628.36
San Jacinto Electric	Electrical Work	P6000626	\$2,600.00	\$0.00	\$2,600.00
San Jacinto Electric	Electrical for Sump Pump	P6001180	\$3,200.00	\$0.00	\$3,200.00
Spectrum Communications	Cabling Phase 2	P6000622	\$359,243.32	\$0.00	\$359,243.32

District: Hemet Unified School District

Printed on: 09/13/2007 at 09:37 AM

Page 10 of 13

© Copyright 2000, Vavrinek, Trine, Day & Company, LLP. All Rights Reserved.



# Expenditure Report

Hemet Unified School District

TAHQUITZ HIGH SCHOOL

Project# 50/67082-00-08

Vendor	Contract Description	PO#/ Contract	Contract Amount	Payments to Date	Balance
Thompson Engineering	Telecenter V Expansion	P6000046	\$61,351.42	\$0.00	\$61,351.42
Trittipo Architecture & Planning	Architect Fees Phase 2 & 3	C11468(70)	\$553,803.50	\$553,803.50	\$0.00
Trittipo Architecture & Planning	Architect Fees	C1220114	\$1,131,287.00	\$0.00	\$1,131,287.00
<b>Totals for Fund (70) Measure T Bond - 28 detail records</b>			<b>\$30,556,697.31</b>	<b>\$6,762,835.96</b>	<b>\$23,793,861.35</b>

To be paid by CFD'S -4,123,808.41

\$26,432,888.90



**Hemet Unified School District  
Expenditure Report  
Rancho Viejo Middle School**

<b>Measure T Bond Allocation</b>	
<b>State Funds</b>	\$ 24,000,000.00
	<u>12,000,000.00</u>
<b>Total Project Budget</b>	<b>36,000,000.00</b>
<b>Total Bond Budget</b>	\$ 24,000,000.00
<b>Committed to Date</b>	<u>16,416,398.25</u>
<b>Bond Balance</b>	\$ 7,583,601.75

# Expenditure Report

Hemet Unified School District  
RANCHO VIEJO MIDDLE SCHOOL

Project# New Middle #4

Vendor	Contract Description	PO#/ Contract	Contract Amount	Payments to Date	Balance
<b>Fund (70) Measure T Bond</b>					
Armed Response Security	Construction Site Security	P6000685	\$108,000.00	\$6,000.00	\$102,000.00
Barnhart Labor Compliance Services	Labor Compliance	C11770	\$241,900.00	\$33,888.00	\$208,012.00
Building Systems Management	SCE Utility Rebate	P54442	\$7,780.00	\$7,002.00	\$778.00
Caldwell Land Surveys	Topographical Survey	P54884	\$1,800.00	\$1,800.00	\$0.00
Caldwell Land Surveys	Land Survey	P58829	\$54,000.00	\$27,000.00	\$27,000.00
California Dept of Education	Site Review Fee	CL110111	\$12,419.85	\$12,419.85	\$0.00
City of Hemet	Waste Removal	P58895	\$1,000.00	\$988.98	\$11.02
DEWCO	Food Facilities Design	P53184	\$12,500.00	\$8,125.00	\$4,375.00
Division of State Architect	DSA Fees	CL101330	\$153,410.00	\$153,410.00	\$0.00
Division of State Architect	DSA Fees	CL106934	\$8,055.00	\$8,055.00	\$0.00
Division of State Architect	DSA Plan Check Fee	CL120572	\$3,960.00	\$3,960.00	\$0.00
douglas e barnhart	Construction Management	C11744	\$1,250,000.00	\$780,917.00	\$469,083.00
douglas e barnhart Trust Acct	Trust Account	C12148(70)	\$12,189,069.86	\$3,346,358.80	\$8,842,711.06
Eastern Municipal Water District	Plan Check Deposit	CL124051	\$4,000.00	\$4,000.00	\$0.00
Eastern Municipal Water District	Water Usage	CL125142	\$69.75	\$69.75	\$0.00
Eastern Municipal Water District	Water Usage	P6001265	\$10,000.00	\$0.00	\$10,000.00
Estes Inspection Services	Inspection	C12102	\$100,000.00	\$31,500.00	\$68,500.00
Inland Foundation Eng Inc	Construction Testing	C12129	\$351,960.00	\$25,719.00	\$326,241.00
Inland Foundation Eng Inc	Preliminary Geotechnical Investigation	CL102725	\$3,000.00	\$3,000.00	\$0.00
Inland Foundation Eng Inc	Compaction & Material Testing	P54799	\$19,470.00	\$19,470.00	\$0.00
Pacific Alarm	Outdoor Perimeter Alarm System	P58570	\$11,038.00	\$0.00	\$11,038.00
Southern California Edison	Establish Electrical Service	CL119369	\$16,451.10	\$16,451.10	\$0.00
Southern California Edison	Electric Usage	CL123177	\$144.38	\$144.38	\$0.00
Southern California Edison	Electrical Usage	P6000138	\$40,000.00	\$1,205.80	\$38,794.20
Thompson Engineering	Telecenter V System	P59824	\$117,060.10	\$0.00	\$117,060.10

District: Hemet Unified School District

Printed on: 09/13/2007 at 09:37 AM

Page 2 of 4

© Copyright 2000, Vavrinek, Trine, Day & Company, LLP. All Rights Reserved.

# Expenditure Report

Hemet Unified School District

RANCHO VIEJO MIDDLE SCHOOL

Project# New Middle #4

Vendor	Contract Description	PO#/ Contract	Contract Amount	Payments to Date	Balance
Thompson Engineering	Bulletin Board System	P59828	\$11,810.21	\$0.00	\$11,810.21
Trittipio Architecture & Planning	Architect Fees	C11707	\$1,687,500.00	\$1,404,388.88	\$283,111.12
<b>Totals for Fund (70) Measure T Bond - 27 detail records</b>			<b>\$16,416,398.25</b>	<b>\$5,895,873.54</b>	<b>\$10,520,524.71</b>

**Hemet Unified School District  
Expenditure Report  
Page Ranch**

**Measure T Bond Allocation  
State Funds**

\$ 12,000,000.00  
to be determined

**Total Project Budget**

**12,000,000.00**

**Current Measure T Budget \***

\$ 1,000,000.00

**Committed to Date**

789,773.26

**Bond Balance**

\$ 210,226.74

\* Additional \$1,000,000 to be allocated from 07/08 bond sale.  
Additional \$10,000,000 to be allocated from 10/11 bond sale



# Expenditure Report

Hemet Unified School District

PAGE RANCH ELEMENTARY

Project# New Elem #5

Vendor	Contract Description	PO#/ Contract	Contract Amount	Payments to Date	Balance
<b>Fund (70) Measure T Bond Funds</b>					
Department of Toxic Substance Control	DTSC FEES	CL110135	\$432.41	\$432.41	\$0.00
Department of Toxic Substance Control	DTSC Fees	CL99439	\$2,767.72	\$2,767.72	\$0.00
douglas e barnhart	Construction Management	C12114	\$50,000.00	\$0.00	\$50,000.00
Flores Lund Consultants	Civil Engineer	C11749	\$446.25	\$446.25	\$0.00
Flores Lund Consultants	Topographic & Boundary Surveys	C11935	\$16,418.50	\$16,418.50	\$0.00
Inland Foundation Eng Inc	Geotechnical Investigation, Geological/Seismic & Flood Review	P53708	\$8,568.00	\$8,568.00	\$0.00
Marshall L. McIntyre	Appraisal	CL123653	\$1,600.00	\$1,600.00	\$0.00
PJHM	Architect Fees	C11824	\$661,900.00	\$344,760.00	\$317,140.00
Planning Center	CEQA Doc's	P52768	\$22,208.47	\$22,208.47	\$0.00
Planning Center	Environmental Assessment	P52882	\$6,771.34	\$6,771.34	\$0.00
Planning Center	Health Risk Assessment	P56413	\$2,728.00	\$2,728.00	\$0.00
Planning Center	Environmental Impact Report	P57837	\$8,749.57	\$8,749.57	\$0.00
Planning Center	Augment Environmental Impact Review	P6000745	\$3,750.00	\$0.00	\$3,750.00
Riverside County Airport Land Use Commission	ALUC Review	RC18383	\$245.00	\$245.00	\$0.00
Riverside County Clerk	Dept Fish & Game Fee	CL119873	\$1,275.50	\$1,275.50	\$0.00
Thomas Olsen Associates	Biological Study	P53036	\$1,912.50	\$1,912.50	\$0.00
<b>Totals for Fund (70) Measure T Bond Funds - 16 detail records</b>			<b>\$789,773.26</b>	<b>\$418,883.26</b>	<b>\$370,890.00</b>



**Hemet Unified School District  
Expenditure Report  
Currie Ranch**

<b>Measure T Bond Allocation</b>	
<b>Developer Fees</b>	\$ 12,000,000.00
<b>State Funds</b>	205,436.00
	<u>to be determined</u>
<b>Total Project Budget</b>	<b>12,205,436.00</b>
<b>Current Measure T Budget *</b>	\$ 1,000,000.00
<b>Committed to Date</b>	<u>848,087.95</u>
<b>Bond Balance</b>	\$ 151,912.05

- \* Additional \$1,000,000 to be allocated from 07/08 bond sale.
- \* Additional \$10,000,000 to be allocated from 12/13 bond sale.

# Expenditure Report

Hemet Unified School District

CURRIE RANCH ELEMENTARY

Project# New Elem #12

Vendor	Contract Description	PO#/ Contract	Contract Amount	Payments to Date	Balance
<b>Fund (70) Meaure T Bond</b>					
douglas e barnhart	Construction Management	C11743	\$50,000.00	\$0.00	\$50,000.00
Flores Lund Consultants	Site Survey	C11936	\$20,223.00	\$4,567.75	\$15,655.25
PJHM	Architect Fees	C11673(70)	\$777,864.95	\$536,893.33	\$240,971.62
<b>Totals for Fund (70) Meaure T Bond - 3 detail records</b>			<b>\$848,087.95</b>	<b>\$541,461.08</b>	<b>\$306,626.87</b>

**Hemet Unified School District  
Expenditure Report  
Issuance Costs**

<b>Current Bond Budget</b>	\$ 750,625.95
<b>Committed to Date</b>	<u>338,205.05</u>
<b>Balance</b>	\$ 412,420.90

# Expenditure Report

Hemet Unified School District

ISSUANCE COSTS MEASURE T BOND

Project# Measure T Issuance Costs

Vendor	Contract Description	PO#/ Contract	Contract Amount	Payments to Date	Balance
<b>Fund (70) Measure T Bond</b>					
Bowie, Arneson, Wiles & Giannone	Bond Counsel Issuance Series A	US Bank 1	\$78,000.00	\$78,000.00	\$0.00
Dale Scott & Co	Financial Advisor Issuance Series A	US Bank 2	\$240,424.05	\$240,424.05	\$0.00
SourceMedia	Legal Advertising Issuance Series A	CL119025	\$1,331.00	\$1,331.00	\$0.00
Standard & Poors	Rating Agency Fee Issuance Series A	US Bank 3	\$17,500.00	\$17,500.00	\$0.00
U S Bank	Bank Administrative Fees Issuance Series A	US Bank 4	\$950.00	\$950.00	\$0.00
<b>Totals for Fund (70) Measure T Bond - 5 detail records</b>			<b>\$338,205.05</b>	<b>\$338,205.05</b>	<b>\$0.00</b>

**HEMET UNIFIED SCHOOL DISTRICT  
INTER-OFFICE MEMORANDUM**

*From the desk of:*

*Richard M. Beck  
Assistant Superintendent,  
Business Services*

**DATE:** September 14, 2007

**TO:** Citizens' Oversight Committee

**SUBJECT:** Hemet High School Phase III

We have attached excerpts from the August 21, 2007 Board presentation. The full presentation is posted on the District website at [www.Hemetusd.k12.ca.us](http://www.Hemetusd.k12.ca.us). Click on the Facilities Department link and then select the Hemet Modernization link.

The Governing Board is reviewing some information they requested at the September 18, 2007 Board meeting and Tina Koonce and Trittipio and Associates will present the latest information at your meeting on September 20, 2007.

RB/cl



Board Presentation  
for  
Hemet High School  
(Expansion /  
Modernization)  
August 21, 2007



TRITTIPO ARCHITECTURE  
& PLANNING

## Hemet High School Facility Background

<u>Permanent Classrooms</u>	<u>Classrooms</u>	<u>Capacity @ 27 students</u>
<u>1970 - Main building</u> kitchen, locker rooms, staff offices all built for this capacity Average classroom square footage = 851 Acreage = 36 acres	55	1485
<u>1984 Additions to Main Building</u> 4 science lab, dance, Art Classrooms	6	162
<u>2006 Stadium Addition</u> 2 classrooms Additional Acreage Added 16 acres (Total 52 acres)	2	-
<b>Permanent Classroom Capacity</b>	63	1647
<u>Relocatable Classrooms</u>	<u>Classrooms</u>	<u>Capacity 25 @ 27 students</u> <u>12 SDC @ 15 students</u>
1984 - Over 23 years old All Priority 1	6	162
1985 - Over 22 years old All Priority 1	10	150
1987 - Over 21 years old All Priority 1	2	30
1989	1	27
1990	9	243
2001	5	135
2002	4	108
<b>Relocatable Classroom Capacity</b>	37	855
<b>TOTAL SITE CLASSROOMS</b>	<b>100</b>	<b>2502</b>



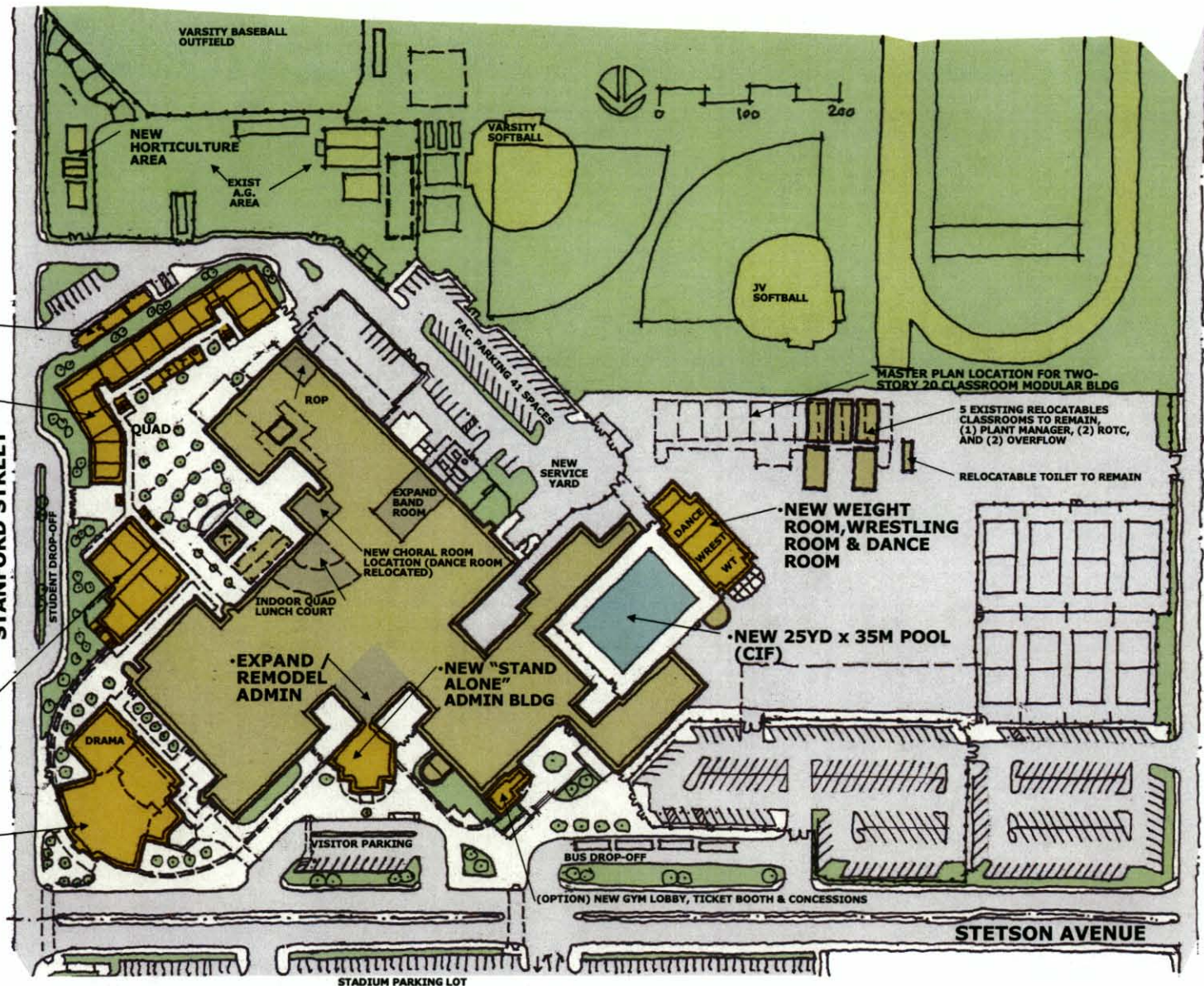

- NEW TEACHING STATIONS**
- 4 SCIENCE LABS
  - 4 SPECIAL ED CLRMS
  - 32 STANDARD CLRMS
  - TOTAL 40 T.S.

NEW ELECTRICAL SERVICE ENCLOSURE

NEW TWO-STORY MODULAR CLASSROOM BUILDING (28 TS)

NEW TWO-STORY MODULAR CLASSROOM SCIENCE BUILDING (12 TS)

NEW 500-SEAT THEATER

DARTMOUTH STREET

STANFORD STREET

STETSON AVENUE

**HEMET HIGH SCHOOL ADDITIONS AND MODERNIZATIONS CONCEPTUAL ESTIMATE 8-6-07**

**Summary (incl 15% contractor mark-up)**

Theater (500 Seat)				\$8,804,900.25
Science Building (4 science rooms and 8 reg classrooms)				\$6,261,733.79
2-Story Regular Classrooms (24 reg classrooms + 4 special ed)				\$10,574,466.20
Parking and Drop-off area				\$1,233,996.00
New Pool				\$1,845,405.00
Courtyard Improvements				\$114,461.80
Demolition (site)				\$570,714.87
Landscaping (site)				\$172,500.00
Misc Costs Items				
1. Storm Drainage Improvements				\$255,875.00
2. Electrical Upgrades to accommodate new work				\$603,750.00
3. Bridge to connect 2-story buildings				\$157,550.00
4. Colonnade from new theater to gym lobby				\$201,250.00
5. Site Lighting				\$138,000.00
Additional Buildings / Building Additions				
1. Dance / Weight Room / Wrestling / Pool Equipment				\$2,515,101.75
2. Administration Addition				\$1,496,017.75
3. New Electrical Utility Enclosure & Equipment				\$437,074.91
Modernizations				
1. Administration Building				\$2,055,625.00
2. ROP				\$543,375.00
3. Band Room and Choral				\$855,312.50
4. Sprinkler Upgrade to Main Complex				\$898,541.00
5. Convert Existing Theater to Interior Lunch Quad				\$200,000.00
 Subtotal				 <b>\$39,935,650.82</b>
 Soft Costs at 20%				 <u>\$7,987,130.16</u>
 Total Including Soft Costs				 <b>\$47,922,780.98</b>
 OPTIONS				
1. Upgrade Lights / Data / Technology at Existing Classrooms				\$925,000.00
2. Gym / Lobby Tickets / Concessions				\$592,231.60
3. Replace bleachers in Gym & upgrade access				\$575,000.00
4. Upgrade to Permanent Construction on 2-Story	SF	32330	\$55.00	\$1,778,150.00
5. Upgrade to Permanent Construction on Science	SF	16485	\$55.00	\$906,675.00
6. Upgrade to 800 Seat Theater + 20% soft Costs				\$4,547,093.10
7. Tennis Court Lighting				\$207,000.00